

RCCN 日成CAP型金属软管末端护套 Metal Flexible Conduit Cap

单位/Unit:mm

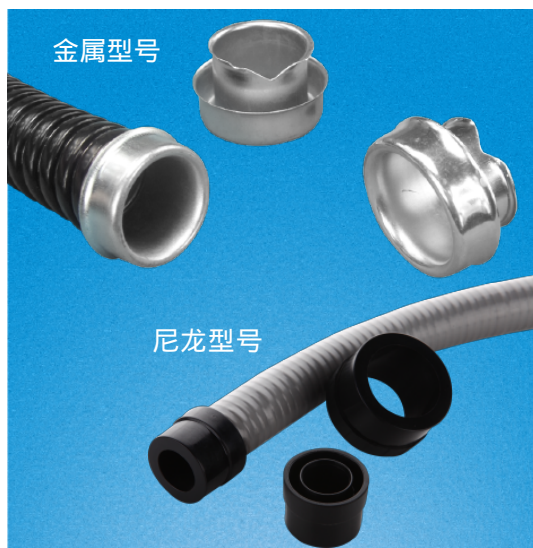

金属型号

尼龙型号

金属型号 Item No.	PA尼龙型号 Item No.	软管规格 Sizes	软管 内径 I.D.	包装 Packing pcs
MCR-01CAP		MCR01	6	50
MCR-02CAP		MCR02	8	50
MCR-03CAP	PA-03CAP	MCR03	10	50
MCR-04CAP	PA-04CAP	MCR04	13	50
MCR-05CAP	PA-05CAP	MCR05	16	25
MCR-06CAP	PA-06CAP	MCR06	20	25
MCR-08CAP	PA-08CAP	MCR08	25	25
MCR-10CAP	PA-10CAP	MCR10	32	10
MCR-12CAP	PA-12CAP	MCR12	38	5
MCR-16CAP	PA-16CAP	MCR16	51	5
MCR-20CAP		MCR20	64	5
MCR-24CAP		MCR24	75	5
MCR-32CAP		MCR32	100	5

RCCN 日成NBG-PA型尼龙金属软管接头 Nylon Flexible Conduit Fittings

单位/Unit:mm

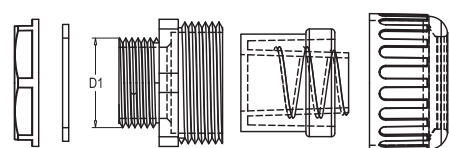

型号 黑色	Item No. 灰色	螺纹规格 Sizes	螺纹长度 Sizes	软管规格 Sizes	软管 内径	包装 Packing
NBG-03MPAB	NBG-03MPAG	M16*1.5	10	MCR03	10	50
NBG-04MPAB	NBG-04MPAG	M16*1.5	10	MCR04	13	50
NBG-05MPAB	NBG-05MPAG	M20*1.5	10	MCR05	16	50
NBG-06MPAB	NBG-06MPAG	M25*1.5	10	MCR06	20	50
NBG-08MPAB	NBG-08MPAG	M32*1.5	10	MCR08	25	20
NBG-10MPAB	NBG-10MPAG	M40*1.5	15	MCR10	32	10
NBG-12MPAB	NBG-12MPAG	M50*1.5	15	MCR12	38	10
NBG-16MPAB	NBG-16MPAG	M63*1.5	25	MCR16	51	10
NBG-03PPAB	NBG-03PPAG	PG16	11	MCR03	10	50
NBG-04PPAB	NBG-04PPAG	PG16	11	MCR04	13	50
NBG-05PPAB	NBG-05PPAG	PG16	13	MCR05	16	50
NBG-06PPAB	NBG-06PPAG	PG21	13	MCR06	20	50
NBG-08PPAB	NBG-08PPAG	PG29	13	MCR08	25	20
NBG-03GPAB	NBG-03GPAG	G1/2	15	MCR03	10	50
NBG-04GPAB	NBG-04GPAG	G1/2	15	MCR04	13	50
NBG-05GPAB	NBG-05GPAG	G1/2	15	MCR05	16	50
NBG-06GPAB	NBG-06GPAG	G3/4	15	MCR06	20	50
NBG-08GPAB	NBG-08GPAG	G1	15	MCR08	25	20
NBG-10GPAB	NBG-10GPAG	G1-1/4	15	MCR10	32	10
NBG-12GPAB	NBG-12GPAG	G1-1/2	15	MCR12	38	10
NBG-16GPAB	NBG-16GPAG	G2	25	MCR16	51	10

RCCN 日成PB-C型直通分线盒 Pull Box

单位/Unit:mm

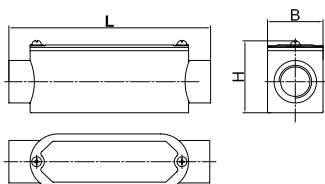
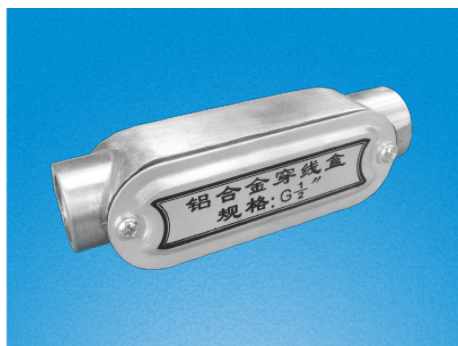

型号 Item No.	螺牙规格 Specification	L mm	B mm	H mm	包装 Packing
PB-C-G1/2	1/2"	118	34	41	每包 5pcs
PB-C-G3/4	3/4"	135	38	48	
PB-C-G1	1"	152	45	52	
PB-C-G1-1/4	1 1/4"	180	54	66	
PB-C-G1-1/2	1 1/2"	190	58	70	
PB-C-G2	2"	252	74	82	
PB-C-G2-1/2	2 1/2"	265	93	110	
PB-C-G3	3"	280	108	120	
PB-C-G4	4"	300	132	140	

产品材质: 铝合金制成.

产品特性: 1. 可直接连接对应外螺纹硬管.

2. 配合日成NBG-G接头和MCR软管接线.

Material: Aluminium metal

Features: 1. can be connected with outer thread rigid conduit directly

2. used with RCCN NBG-G connectors and MCR flexible conduit